

Nasal Swab Kit



Specimen Collection and Shipping Instructions

Kit Components:

1. Flocked swab
2. Viral transport medium
3. Specimen label
4. Specimen transport bag
5. Test Requisition Form (TRF)
- Stored in the outside pocket of transport bag

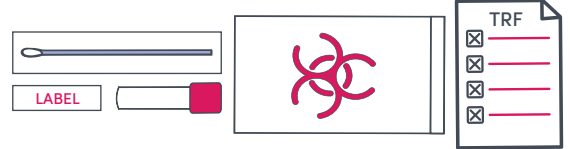

STEP 1

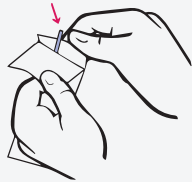

Peel open the pouch from the side marked with the arrow and remove the NP swab.

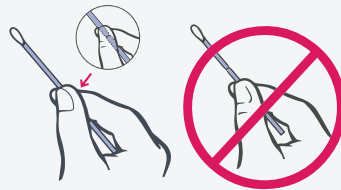

Hold the NP swab at the breakpoint line. Do not hold the swab shaft below the breakpoint line.

STEP 2

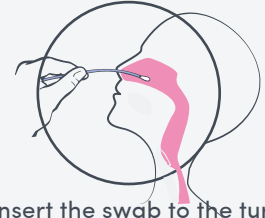

Gently insert the swab to the turbinate (less than 1 inch into naris). Rotate against nasal wall for 3-5 secs. Repeat in other nostril with the same swab.*

STEP 3

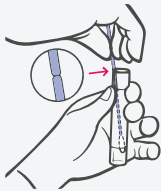

Insert the swab into the vial of viral transport medium

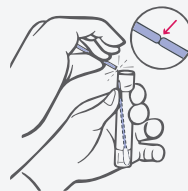

Carefully bend and break the swab at the printed breakpoint line.

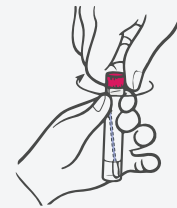

Replace the vial cap, securing tightly.

STEP 4



Specimens **must** be labeled with the following (optional specimen label is included with kit):

- Two patient identifiers - Patient first and last name **and** DOB or medical record number (MRN)
- Sample collection date

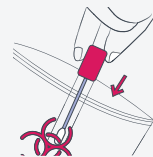

Insert tube into specimen transport bag and seal.

STEP 5



- Complete a test requisition form (TRF) for each sample.
- Insert all paperwork into the outside pocket of the transport bag.
- Paperwork should **NOT** be inserted into the transport bag with the sample.

SHIPPING AND STORAGE INSTRUCTIONS

- Keep specimens on refrigerant gel packs or refrigerated (2-8° Celsius) prior to shipping.
- Specimens must be shipped within 72 hours of being collected (24 hours preferred).
- Ship specimens with refrigerant gel packs (preferred)